

Before programming, please read carefully the general guidelines and all comments related to each stage of programming.

### 1. | Transmitter or channel programming |

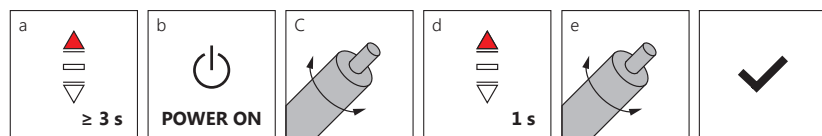

before start --- switch the power OFF

- a) Press and hold down button for 3 s
- b) after 3 s still holding button switch the power ON
- c) motor should move up-down shortly to confirm programming mode (you can now release button)
- d) Press again button for 1 s
- e) motor should move up-down shortly to confirm programming successful

### 2. | Change direction |

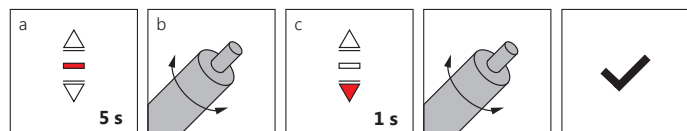

### 3. | Top limit position setting

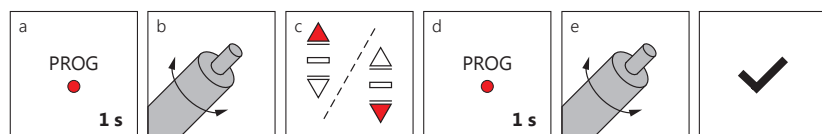

- a) First press of the **PROG** button should be done a little bit lower than desired bottom bar position.

### 4. | Other limit position setting |

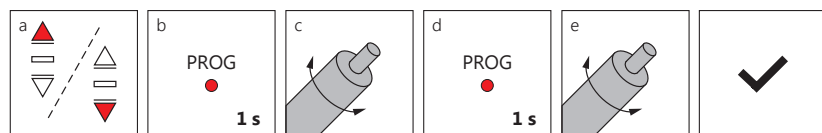

### 5. | Limit position fine-tuning |

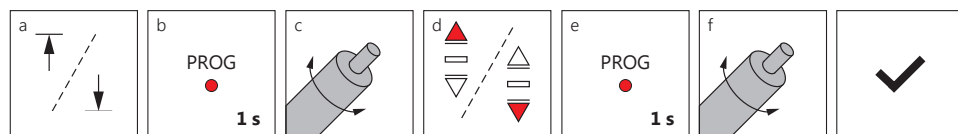

- a) Set the motor in given limit position.

### 6. | Delete the limit position |

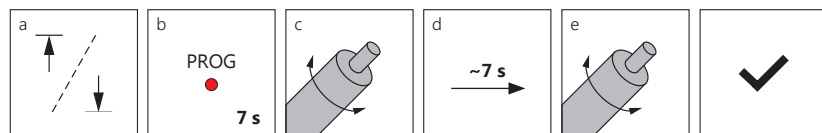

- a) Set the motor in given limit position.

### 7. | Dot move<sup>1)</sup> and continuous move<sup>2)</sup> conversion |

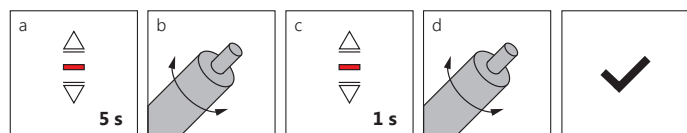

- 1) Pressing or will cause move to the nearest middle/end position.
- 2) Pressing or will cause short move - rotation of slats.

### 8. | Add the new transmitter or channel |

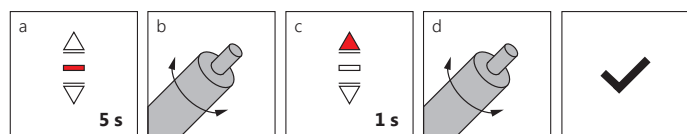

- c) Press button on the new transmitter.

### 9. | Delete transmitter or channel |

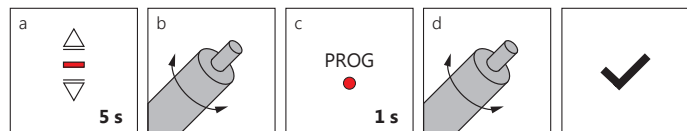

## 10. | RESET - Delete all settings

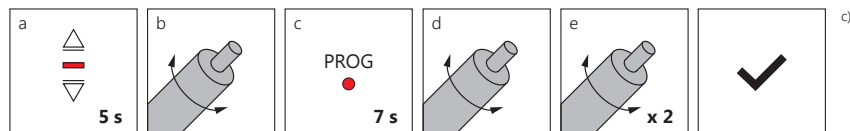
c) Press and hold the **PROG** button until it reaches the step e).

## Troubleshooting

	Problem	Matter	Troubleshooting
1.	When powered on motor doesn't work or work slowly.	<ul style="list-style-type: none"> <li>a. No transmitter had been set.</li> <li>b. The voltage is wrong.</li> <li>c. Overloading.</li> <li>d. Wrong installation causing stuck.</li> </ul>	<ul style="list-style-type: none"> <li>a. Set the limit positions using the transmitter.</li> <li>b. Change or measure voltage (230 V AC).</li> <li>c. Unload the mechanism down to the proper weight.</li> <li>d. Check the motor's installation to ensure there is nothing that can stop the rotation.</li> </ul>
2.	When powered on motor works in one direction only.	Motor stopped on one of the limit positions.	Rotate crown 1 or 2 circles by hand on the opposite way to the motor current running direction (section 10).
3.	The motor stopped suddenly.	<ul style="list-style-type: none"> <li>a. Power off/failure.</li> <li>b. Motor had been overheated (continuous work time equals to ca. 4 min - depend on ambient conditions).</li> </ul>	<ul style="list-style-type: none"> <li>a. After connecting with the power, the motor will be able to work.</li> <li>b. Wait until the unit temperature fall down.</li> </ul>
4.	Motor is running to the opposite way to the transmitter's ▲ and ▼ buttons.	Due to the side if motor installation, changing of rotating directions may be required.	Change rotating direction - see: section 2.
5.	After pressing ▲ or ▼ buttons, motor reacts only by „jogging“ a little.	Due to the type of blind which motor is installed in, changing of the mode may be required.	Check motor's mode - see: section 7.