

WAZ Vertical blind – motorised

	Min.	Max.
Width	500 mm	4000 mm
Height	500 mm	4000 mm

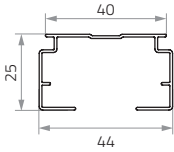

A-2000 Rail



COLOUR	white	grey	silver	anthracite	black
motorised vertical blind	✓				

PLEASE NOTE:

- 1. Maximum recommended size of the blind is specified in the table.
- 2. Slight variations in the shade of slats made of fabric may occasionally occur.
- 3. The stack of 127 mm slats moved aside to one side takes up 9 cm/1 m of the blind's width + 7 cm distance from the control unit.
- 4. The stack of 89 mm slats moved aside to one side takes up 13 cm/1 m of the blind's width + 5 cm distance from the control unit.
- 5. The final price of system "5" blind is the sum total of any two blinds of type "1" and/or type "2".
- 6. Extra charge for a vertical blind with 89 mm wide fabric (original or cut-to-length) is based on the price of the vertical blind with manual drive, see pp. 343-345.

ADDITIONAL OPTIONS		
Name		Comments
Vertical blind with 89 mm wide slats trimmed to size from 127 mm original width		
Vertical blind with slats 89 mm wide (the original width of the fabric)		



B2 Top bracket (metal)



A2 Wall bracket

ADDITIONAL OPTIONS

Extra slat weight: 127 mm slat - 0,15 EUR/pc , 89 mm slat - 0,13 EUR/pc.
Extra connecting ball chain (127, 89 mm slats) - 0,26 EUR/pc.

