

Vertical blind Basic

| Manual |

89/127 mm



persiennbutiken.se persiennner-online.se persiennner.nu

Read the instructions carefully before assembling and using the product. Assembling process can be completed by non-professionals. For indoor use only.

/ WARNING /

Young children can be strangled by loops in pull cords, chains, tapes and inner cords that operate the product. To avoid strangulation and entanglement, keep cords out of the reach of young children. Cords may become wrapped around a child's neck. Move beds, cots and furniture away from window covering cords. Do not tie cords together. Make sure cords do not twist and create a loop.

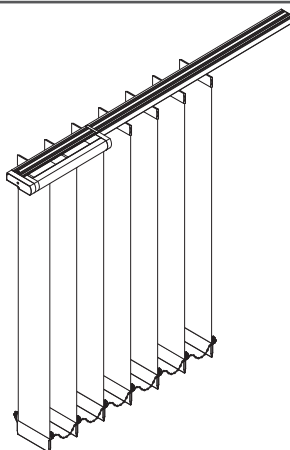
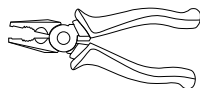
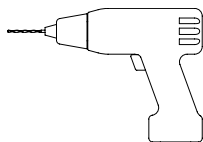
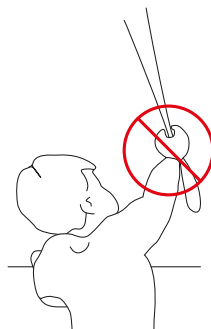

! / ATTENTION /

Instruction shows montage of the round rail to hanger. For the rectangular rail montage do the same steps. Bracket can be installed to ceiling or to the adjustable extension.

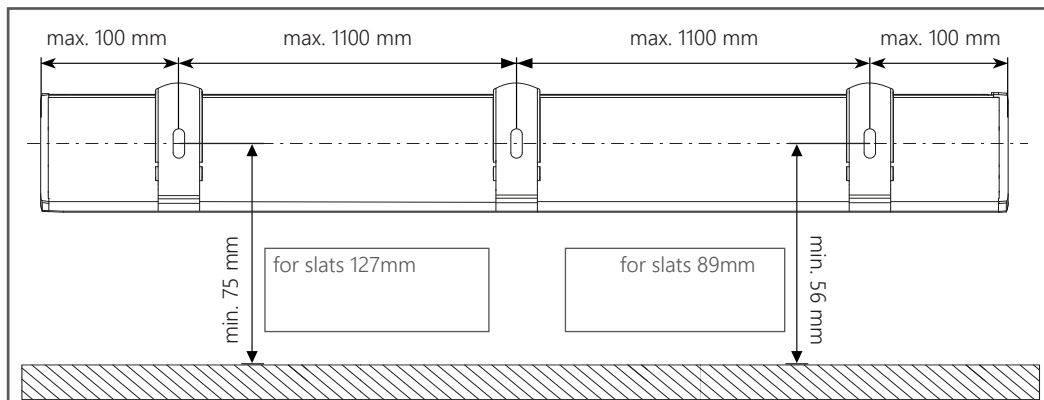
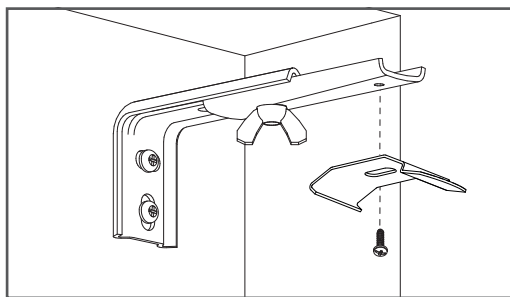
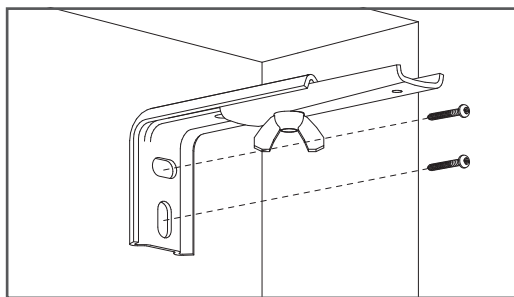
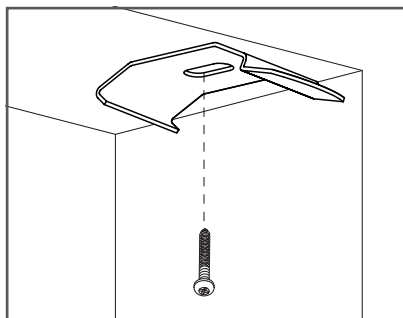
**| Adjustable extension |****| Bracket clip |**

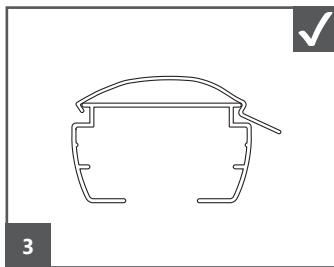
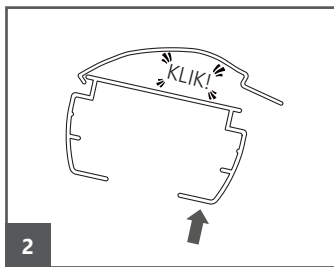
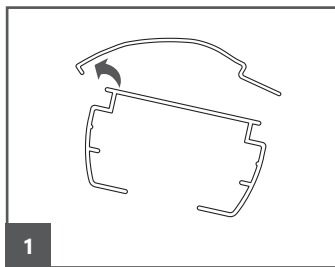

! / WARNING /

Install the child safety device as specified in the separate CHILDSAFETY manual.

| Slats |

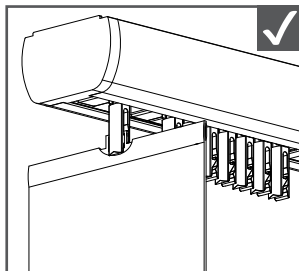
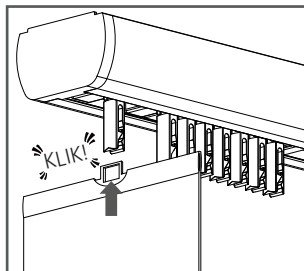

! / ATTENTION /

PVC slats should be installed in the same way.

| Chain |

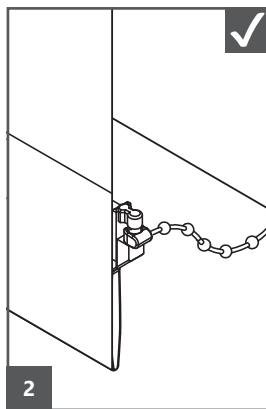
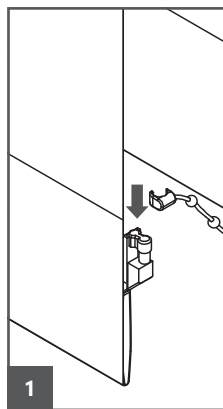
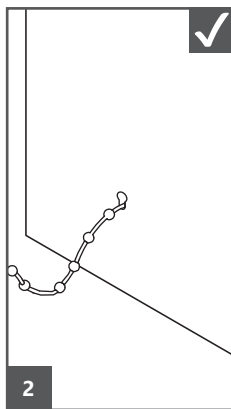
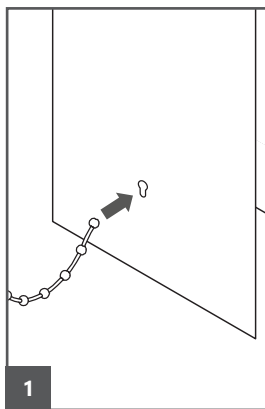

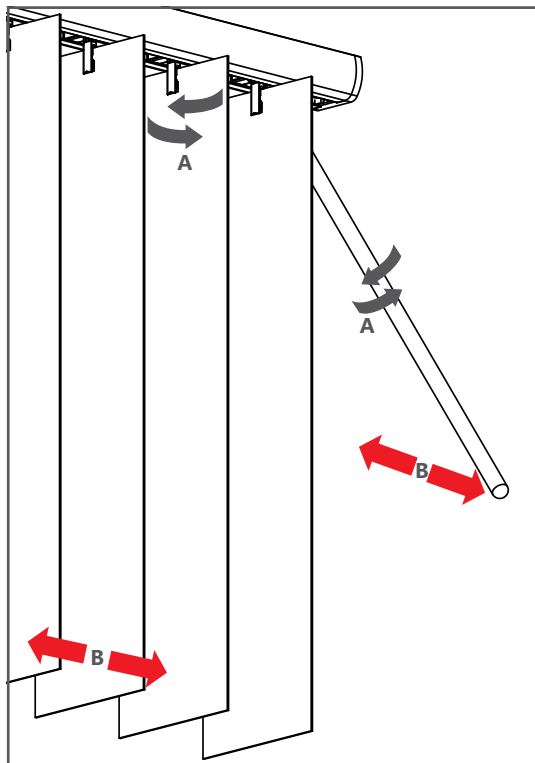
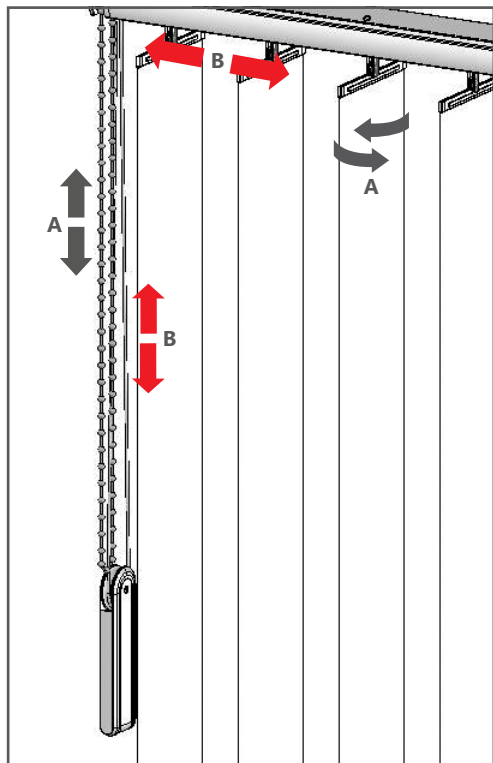
**Motorized control**

please read the separated programming and electric controlling manual.

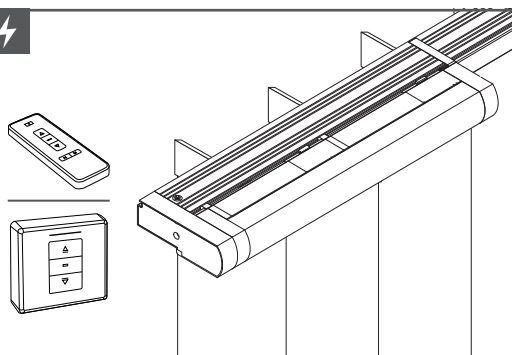

The product should be regularly wiped with a soft cloth. Do not use cleaning agents. To keep the product in good working order, the slats should be moved and rounded regularly.

Programming of electric vertical blinds

persiennbutiken.se persiennner-online.se persiennner.nu

Read the instructions carefully before assembling and using the product. Assembling process can be completed by non-professionals. For indoor use only.

Compact drive Trietex 24 V DC

Compact drive Trietex 24 V DC for vertical blinds 89/127/250 mm can be installed in rectangular rail only.

The drive is suitable for control through voltage polarisation change. Before assembling make sure that 24 V DC switch allows to such a control. The drive can be mounted in front of or behind rail (by default it is installed behind).

Compact drive consists of two motors responsible for slats movement and rotation. The drive requires to set end position switches by hand for both motors – in total four positions. The drive is equipped with anti-overload system, which stops motor in case of overload. **To ensure proper operation end positions should be absolutely set.**

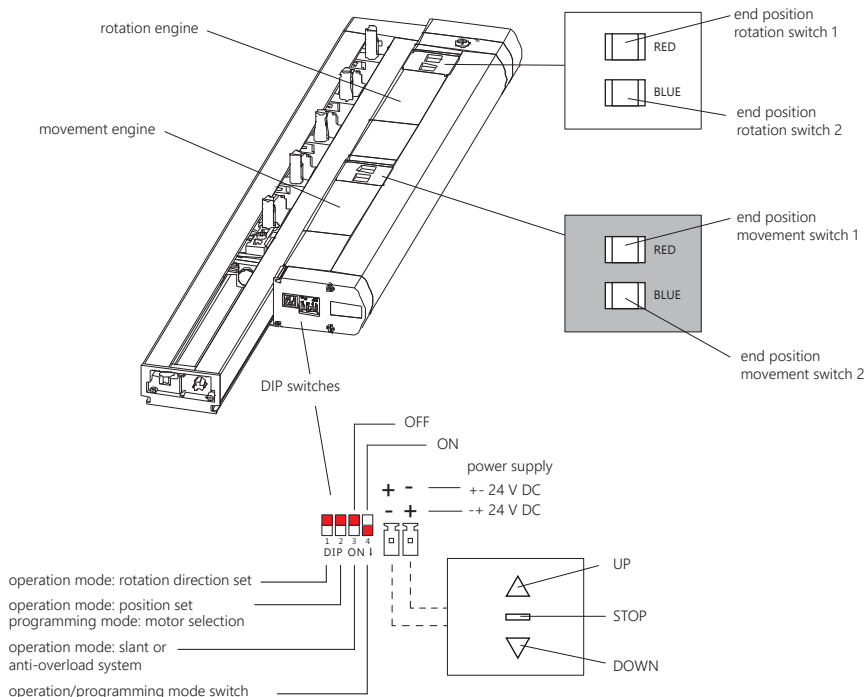

General guidelines for drive setting

- Switches DIP 2 and DIP 4 serve to set end positions.
- When setting, switches DIP 1 and DIP 3 should be at OFF position (see: last page of manual).
- To cause a movement when setting (DIP 2 and 4 on), press end position switch and UP/DOWN.
- End position switches have two states: 'soft' – click can be heard after pressing – position not set, 'hard' – position set.

Setting end movement positions

1. Turn slats to open position and press STOP.
2. Set DIP 2 and 4 ON – programming mode is active.
3. Start the movement to the left or right pushing one of the end position switches ('soft' – click can be heard after pressing) and UP/DOWN.
4. Move master carriage to the right position.
5. After achieving correct position, release end position switch, press STOP – the first end position is set.
6. Repeat steps 3-5 to set other end position.
7. Switch DIP 4 OFF – programming mode is off.

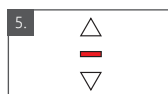
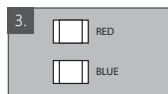
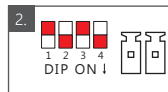
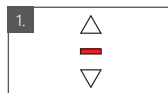

Setting end rotation positions

1. Turn slats to open position and press STOP.
2. Set DIP 4 ON – programming mode is active.
3. Start the movement to the left or right pushing one of the end position switches ('soft' – click can be heard after pressing) and UP/DOWN.
4. Rotate carriages about 90 degrees from open position.
5. After achieving right position, release end position switch, press STOP – the first end position is set.
6. Repeat steps 3-5 to set other end position.
7. Switch DIP4 OFF – programming mode is off.

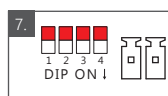
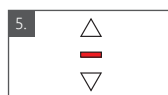
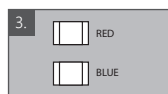
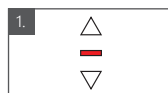

/Not recommended !! / Deleting end movement positions

1. Take out motor.
2. Set DIP 2 and 4 ON – programming mode is active.
3. Move drive to the first end position (UP).

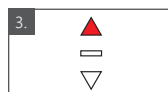
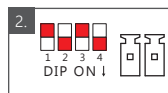

4. Press STOP.

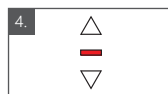

5. Press appropriate end position switch ('soft' – click can be heard after pressing).

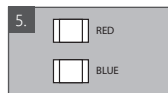

6. Keep pushing the switch and start the movement in the opposite direction (DOWN).

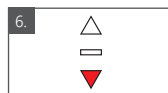

7. Wait until drive stops itself.

8. Press STOP.

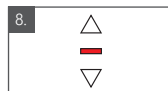

9. Switch DIP 4 OFF – programming mode is off.

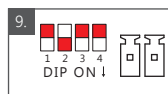

10. Before remounting, master carriage has to be placed in the middle of rail, slats have to be aligned and fully opened.

/Not recommended !! / Deleting end rotation positions

1. Take out motor.

2. Set DIP 4 ON – programming mode is active. v

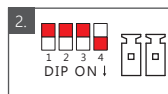

3. Move drive to the first end position (UP).

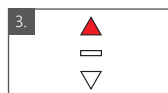

4. Press STOP.

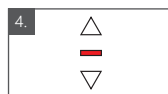

5. Press appropriate end position switch ('soft' – click can be heard after pressing).

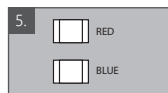

6. Keep pushing the switch and start the movement in the opposite direction (DOWN).

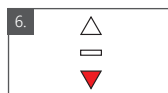

7. Wait until drive stops itself.

8. Press STOP.

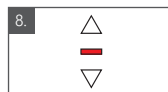



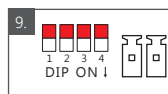







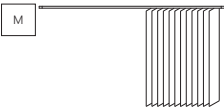
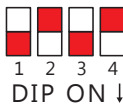
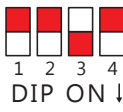
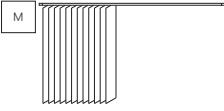
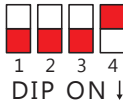
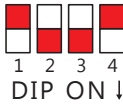
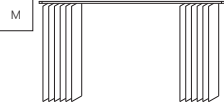
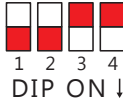
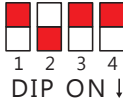
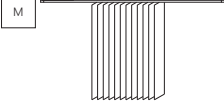
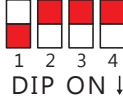
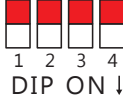

9. Switch DIP 4 OFF – programming mode is off.



10. Before remounting, master carriage has to be placed in the middle of rail, slats have to be aligned and fully opened.

Setting motor according to the system requirements

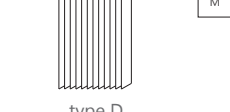
Motor can be set depending on the chosen option:

Option	DIP switches	
 type A	 1 2 3 4 DIP ON ↓ turn left	 1 2 3 4 DIP ON ↓ turn right
 type B	 1 2 3 4 DIP ON ↓ turn left	 1 2 3 4 DIP ON ↓ turn right
 type C	 1 2 3 4 DIP ON ↓ turn left	 1 2 3 4 DIP ON ↓ turn right
 type D	 1 2 3 4 DIP ON ↓ turn left	 1 2 3 4 DIP ON ↓ turn right
 type A	 1 2 3 4 DIP ON ↓ turn left	 1 2 3 4 DIP ON ↓ turn right
 type B	 1 2 3 4 DIP ON ↓ turn left	 1 2 3 4 DIP ON ↓ turn right
 type C	 1 2 3 4 DIP ON ↓ turn left	 1 2 3 4 DIP ON ↓ turn right
 type D	 1 2 3 4 DIP ON ↓ turn left	 1 2 3 4 DIP ON ↓ turn right