

Persiennor system V13

Horizontal blinds V13 system

| Manual |

Läs instruktionerna noggrant innan du monterar och använder produkten. Monteringsprocessen kan utföras av icke-professionella. Endast för inomhusbruk.

Read the instructions carefully before assembling and using the product. Assembling process can be completed by non-professionals. For indoor use only.

VARNING/ WARNING /

Små barn kan strypas av öglor i dragsnören, kedjor, tejper och innersnören som driver produkten. För att undvika strypning och intrassling, förvara linor och snören utom räckhåll för små barn. Dessa persiennedelar kan lindas runt ett barns hals och utgör då en fara. Flytta bort sängar, barnsängar och möbler från fönstert. Knyt inte ihop snören. Se till att dessa inte vrids så att dem skapar en ögla.

Young children can be strangled by loops in pull cords, chains, tapes and inner cords that operate the product. To avoid strangulation and entanglement, keep cords out of the reach of young children. Cords may become wrapped around a child's neck. Move beds, cots and furniture away from window covering cords. Do not tie cords together. Make sure cords do not twist and create a loop.

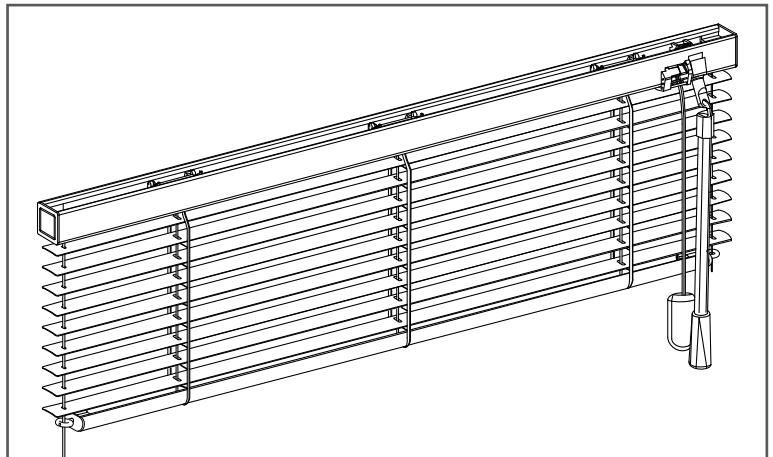
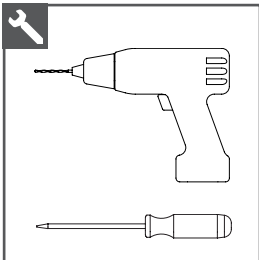
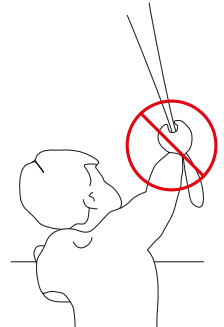

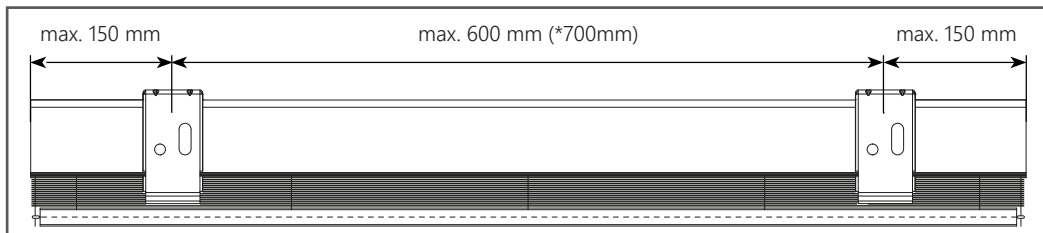

* Gäller Aluminium persienner. | Applies to Aluminium slats. |

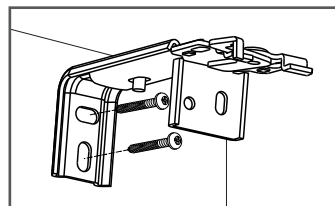
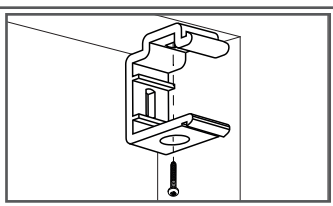
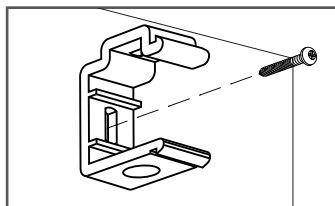
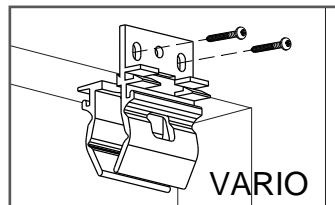
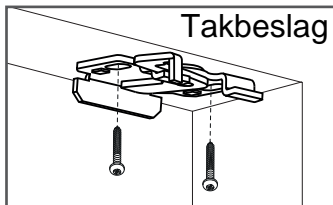
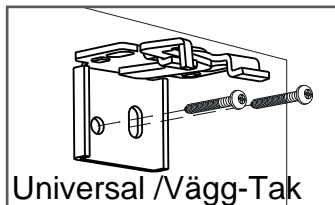

Monteringstyper | Montage |

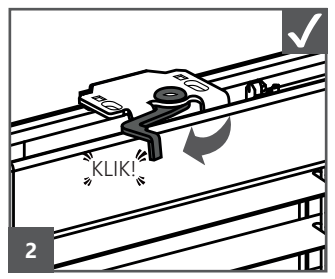
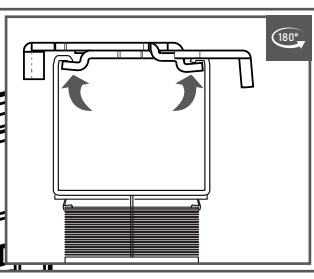
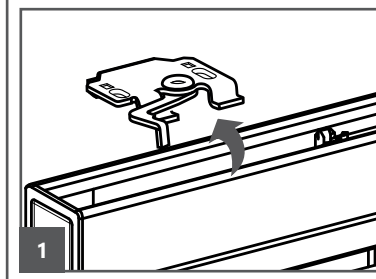
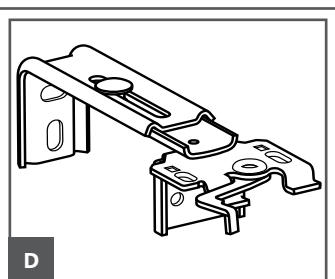

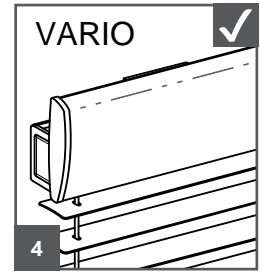
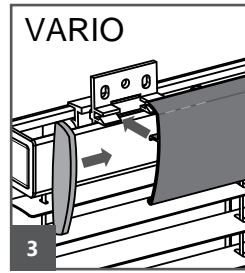
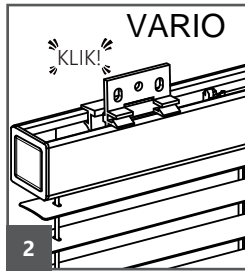
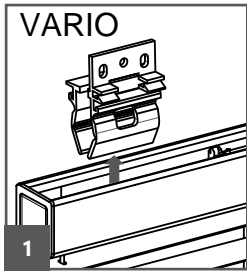
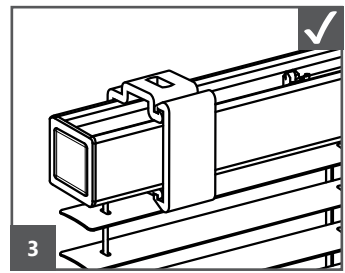
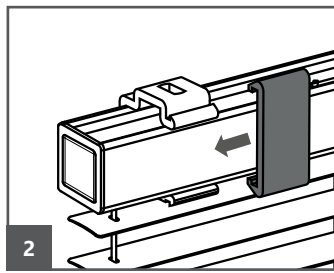
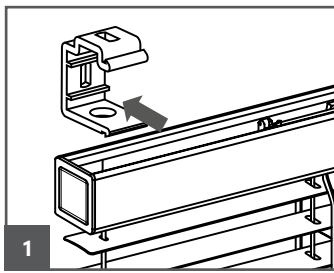

Sido beslag | Side brackets

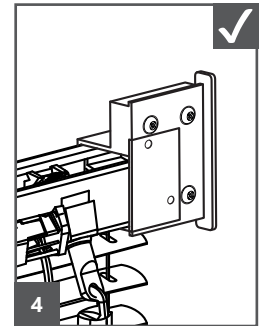
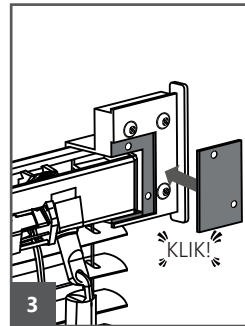
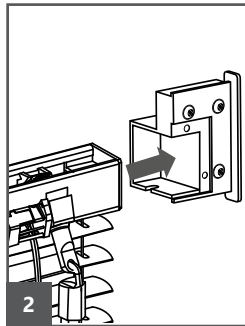
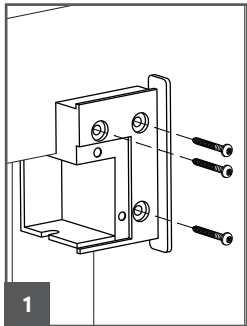

⚠ VIKTIGT / WARNING /

Använd lämpliga barnsäkerhets-detajler som beskrivs i separata manualer.

Install the child safety device as specified in the separate CHILDSAFETY manual.

Montering av sido-wire | Tension brackets montage



Montera komponenter för sidostyrning i enlighet med instruktioner

Install the tension brackets as specified in the separate manual.

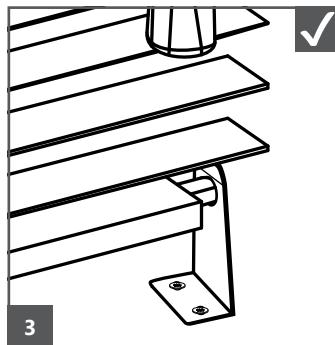
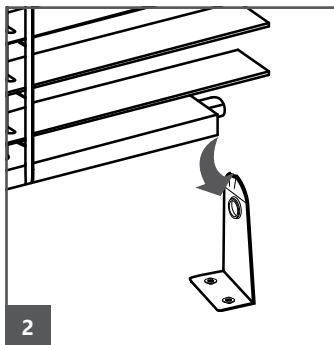
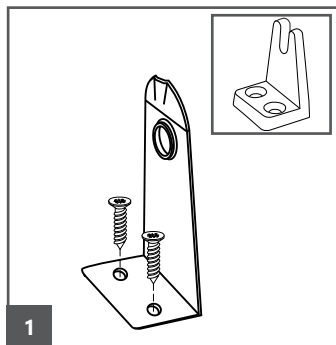

Användning | Operation |

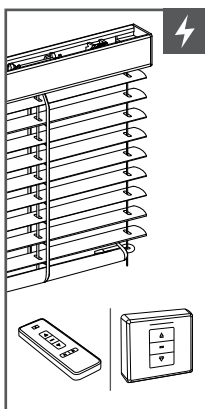
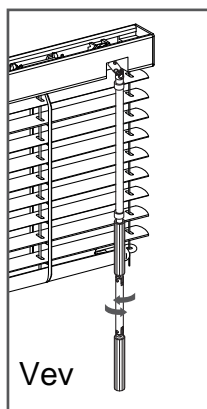
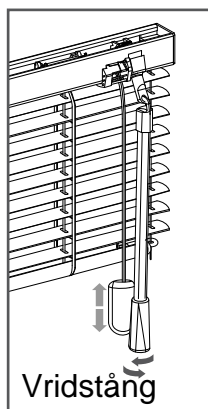

Styrning med el-motor
läs instruktioner gällande motorstyrning

Motorized control
please read the separated programming and electric controlling manual.

Skötselråd | Maintenance |

Vi rekommenderar att minst en gång per månad torka av persiennlameller med torr mikrofiber duk eller en väl urvriden fuktig svamp eller trasa.

Blinds should be vacuumed at least once a month and cleaned with a soft cloth or a with a lightly wet sponge.

Akcesorier Child Safety

Child Safety accessories

| Manual |

Läs instruktionerna noggrant innan du monterar och använder produkten. Monteringsprocessen kan utföras av icke-professionella. Endast för inomhusbruk.

Read the instructions carefully before assembling and using the product. Assembling process can be completed by non-professionals. For indoor use only.

VARNING / WARNING /

Små barn kan strypas av öglor i dragsnören, kedjor, tejper och innersnören som driver produkten. För att undvika strypning och intrassling, förvara linor och snören utom räckhåll för små barn. Dessa persienndelar kan lindas runt ett barns hals och utgör då en fara. Flytta bort sängar, barnsängar och möbler från fönstert. Knyt inte ihop snören. Se till att dessa inte vrids så att dem skapar en ögla.

Young children can be strangled by loops in pull cords, chains, tapes and inner cords that operate the product. To avoid strangulation and entanglement, keep cords out of the reach of young children. Cords may become wrapped around a child's neck. Move beds, cots and furniture away from window covering cords. Do not tie cords together. Make sure cords do not twist and create a loop.

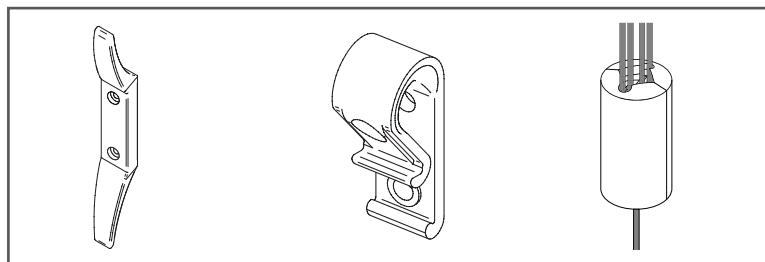
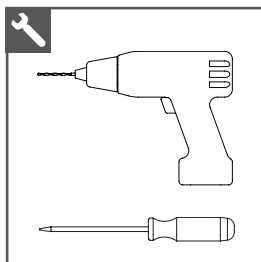
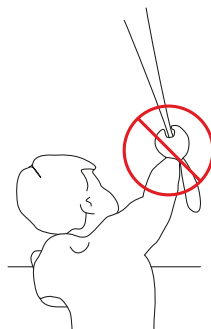

Kulkedje hållare | Chain tensioner

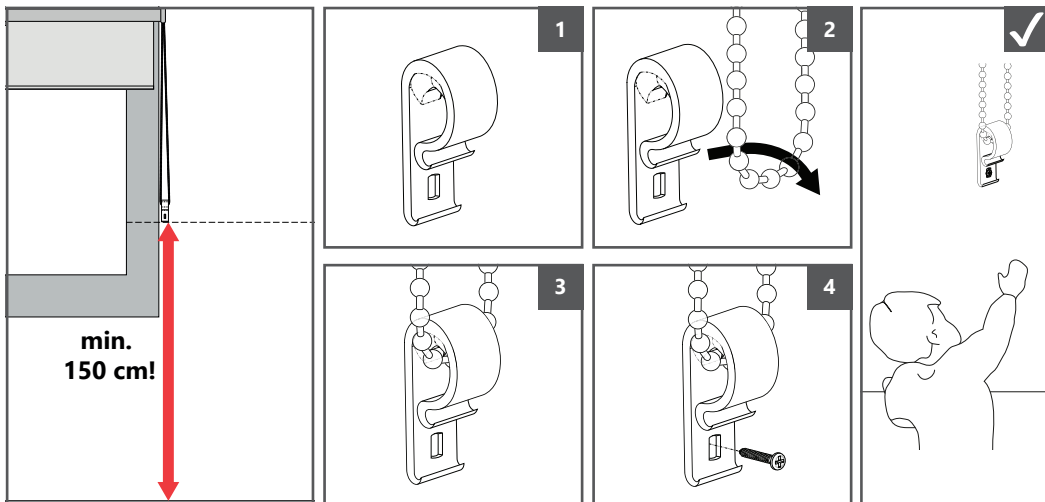

Linhållare | Cord cleat

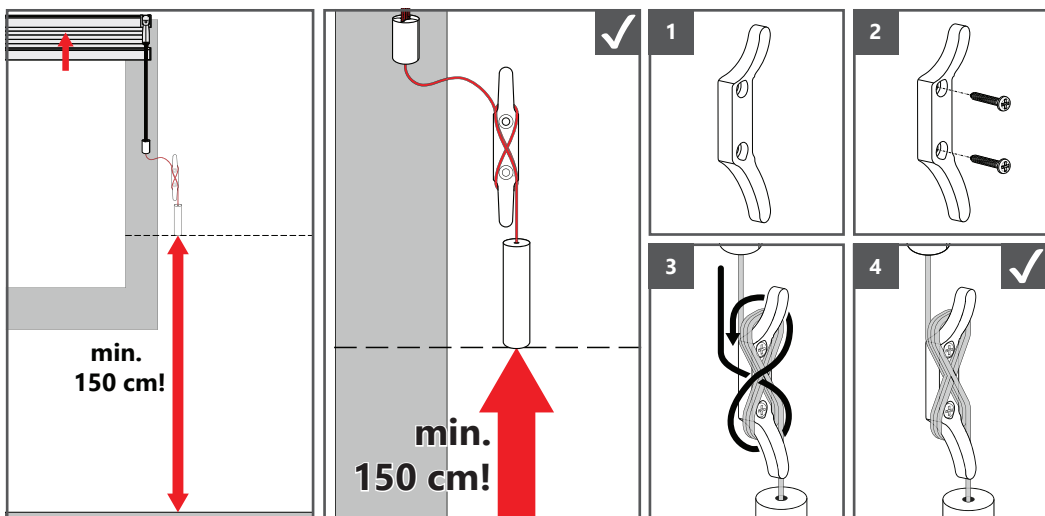

Säkerhets-lintofs | Break away tassel

